



THE CONVENT AT BRAG

Application Info Pack

Expressions of Interest 2019



Image: Helen Seiver, Birdland Goldilocks, 2008, Found wheels, sticks, blanket, and embroidery thread, variable.

About BRAG

Bunbury Regional Art Gallery (BRAG) is a place for art and a catalyst for ideas in the South West of WA. We offer experiences that enrich and strengthen our regional communities. BRAG has several exhibition spaces across two floors of our heritage listed building. BRAG presents the work of WA and South West regional artists in particular, at all stages of their careers. BRAG also houses the City of Bunbury art collection, which includes significant works from noted Indigenous, South West and Western Australian artists. BRAG is also host to many world class travelling exhibitions. Our diverse audience focussed programs of exhibitions and public programs provide new ways to think about art and participate in creativity. Our programs include events, functions, classes and workshops. BRAG offers insightful and dynamic experiences of historic and contemporary Australian artists work and brings the art of the world to the South West.

Expressions of Interest

BRAG is seeking expressions of interest from new and emerging artists to contribute to our programme between January and November 2019. Applications will be accepted from individual artists, artist groups or curators and we are looking for projects with a strong connection to Bunbury or the South West.

Works should not have been shown previously in Bunbury and been created in the 18 months prior to exhibiting in The Convent.

Works in all mediums will be considered, however the Convent Gallery has limited suitability for audio-visual work. Two-dimensional works are encouraged use the Gallery hanging system.

FAQ

What costs are involved?

It is free to exhibit in BRAG's Convent Gallery. However, we do ask all artists to insure their works for the duration in and transport to and from the Gallery.

Can I sell my work?

Yes. A commission of 22% will apply on all works, so please factor this in when you price your art.

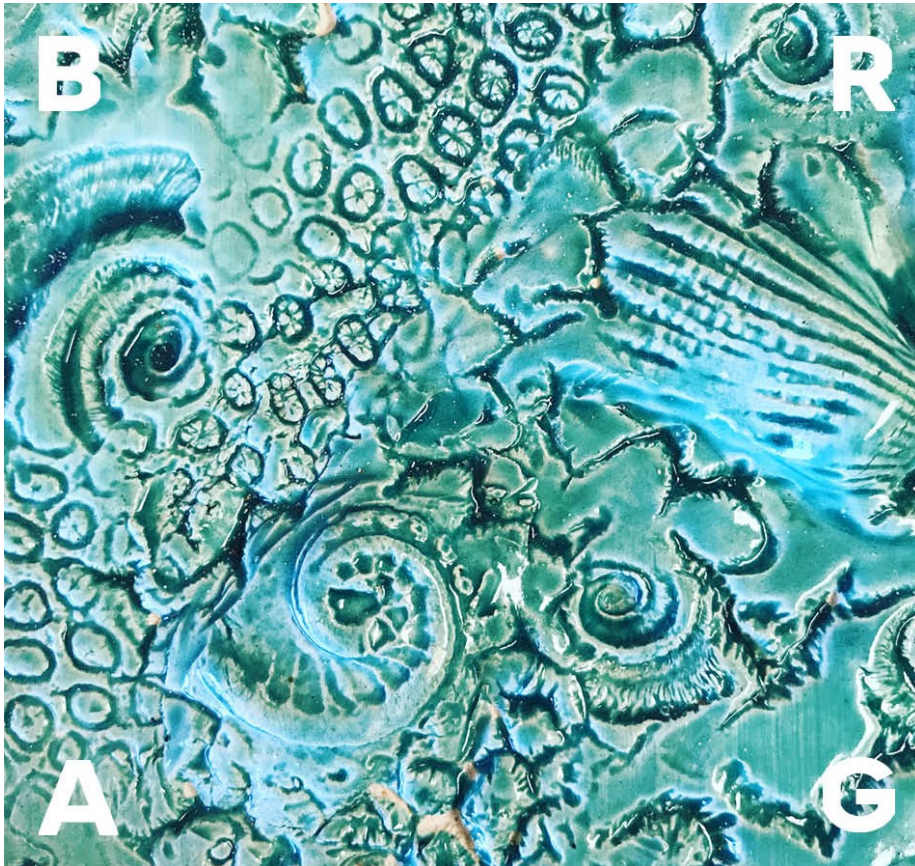

Image: Tracie Anderson, *Reef Life* (detail), 2017, porcelain tiles, 60 x 60 cm

FAQ

What should I write in my EOI?

In describing your exhibition proposal, you are encouraged to consider the following questions:

What is the format your project/artwork will take (e.g. painting, performance, installation)?

What materials, resources will you use and what timeframes will be required to realise your project? (if your works require plinths, please let us know)

What is the conceptual or ideological basis behind your project?

What is the significance of your project in the context of your own practice?

Will I install my own work?

Your work should be fully developed and ready to install. We invite artists to have a chat to our Exhibition Officer, Simon Long, who will install all exhibitions. Simon will assist you in laying out your exhibition and will handle any installations, hanging, lighting etc using BRAG's professional hanging system or exhibition furnishings. Please discuss all requirements with the Admin team and Exhibition Officer.

What else does BRAG provide?

All exhibitions will be given a room didactic/wall information panel and wall labels for individual works. BRAG will market your project through its networks of local and social media, email mail outs, website and digital newsletter.

Please contact BRAG staff for information about additional costs for an opening night if required.

Do you have any general tips?

Please do consider the unconventional gallery space, its size, features, and cultural context. Consider what sort of project would successfully fill the space and the resources (including time) that need to be committed to see it realised.

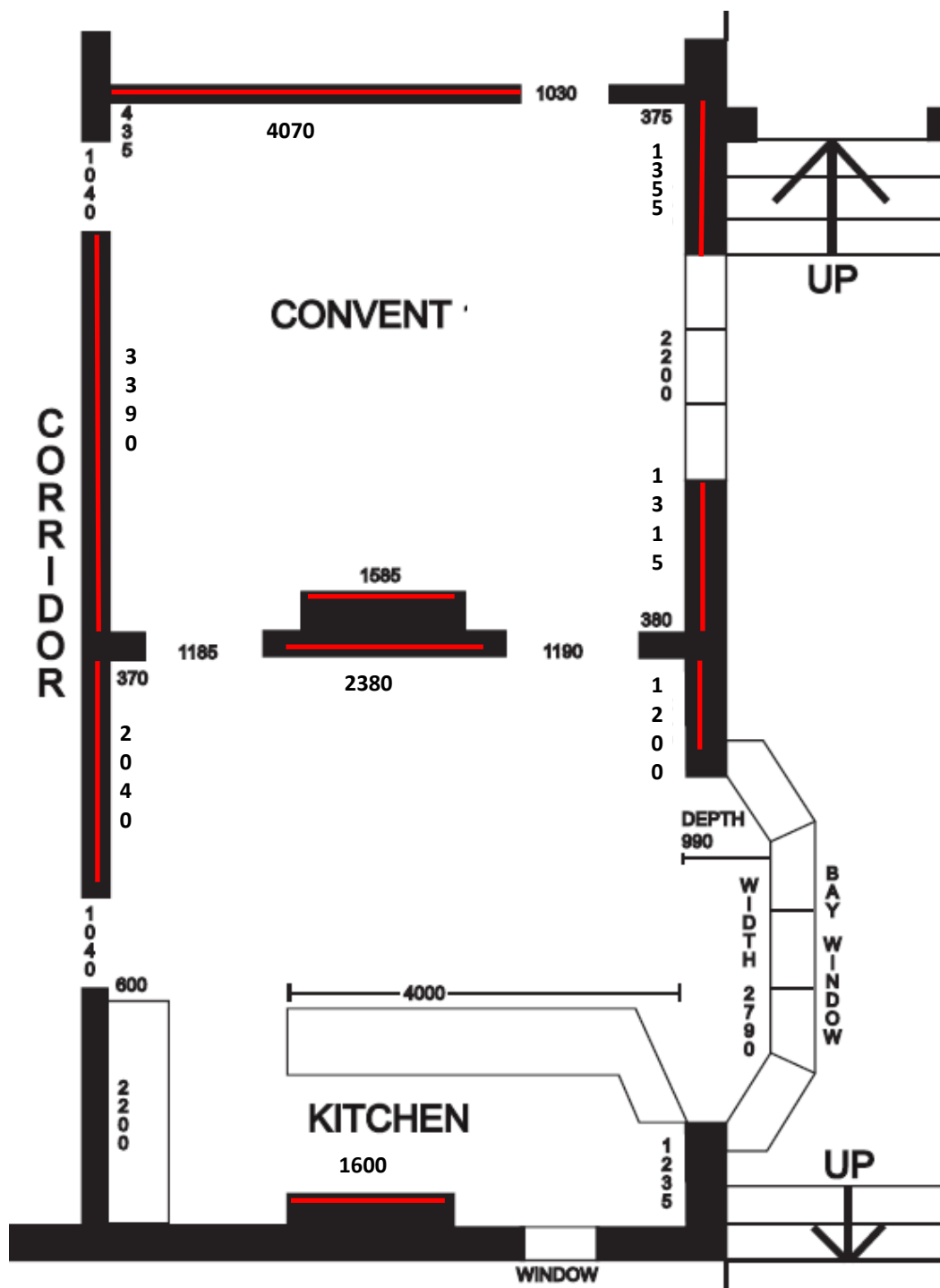

The Convent

The Convent gallery space is approximately 22 square meters total in area. It is divided by a non-functioning fireplace and houses a kitchenette on the south wall.

The areas marked in red in this diagram are wall spaces which can be used for hanging.

BRAG uses a hanging system which requires D hooks on all framed works.

Walls are made of brick and plaster, so please contact the Exhibitions Officer should you have any requirements regarding different attachments.

Two large windows admit natural daylight, and are equipped with dimming (not black out) roller blinds which can draw if required.



To Apply

Please submit a one page, typed proposal outlining your plans for your project/exhibition and why it is a good fit for The Convent.

Attach a short bio/CV relating to your arts practice. If you are applying for a group or as a curator, please attach a one paragraph artist bio for each exhibiting artist. Also include any support materials, such as photos of past works.

Applications close **8 October 2018**.

EOIs will be assessed by a BRAG staff panel. Successful applicants will be contacted to discuss the project in further detail and to assign a suitable timeslot in BRAG's exhibition calendar.

Decisions will be advised no later than 1 November 2018.

If you have any questions, please contact Anna on 08 9792 7320 or aedmundson@bunbury.wa.gov.au

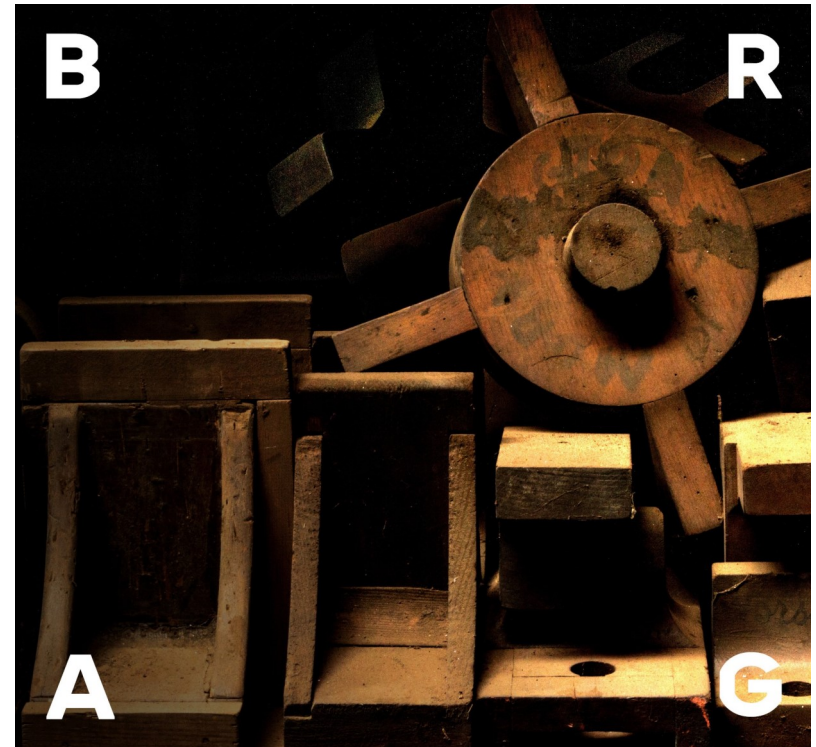

Image: John Stachlewski, *Heritage 1*, 2015, photograph, 305 x 457mm (detail).



**BUNBURY
REGIONAL
ART
GALLERY**
WILGER
MIA



Department of
**Local Government, Sport
and Cultural Industries**

